

# Bristol Maid™

Hospital Metalcraft™ Limited

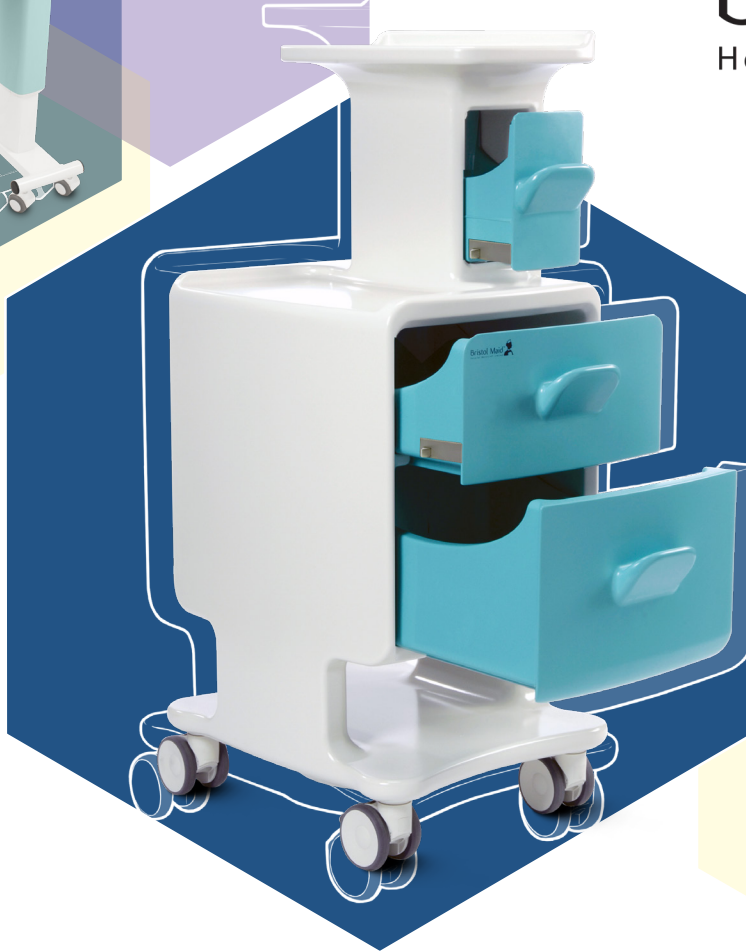

## eClean™



Next Generation Furniture For the Medical World

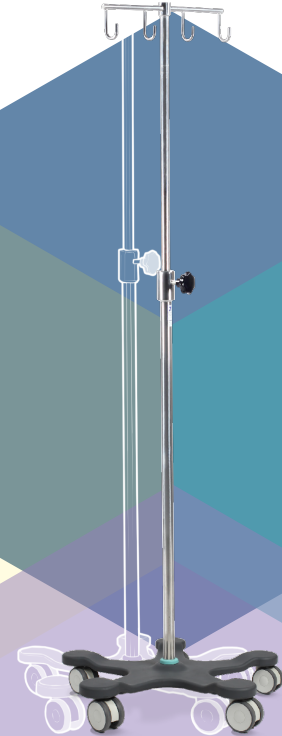

## Medical Furniture & Equipment 2023

Founded in 1953, Bristol Maid has been manufacturing and supplying medical furniture & equipment for over 65 years. From design and manufacture to supply and installation, Bristol Maid has a reputation for providing high product quality, excellent customer service and value for money. We take pride in working in close partnership with our customers to deliver effective solutions based on innovative design and technology that will meet the demands of today while anticipating the solutions for tomorrow.

Our highly-trained staff are experienced in every aspect of customer support, from simple product selection to bespoke technical solutions, from on-site audits to complex project management arrangements, according to our customers' needs. Bristol Maid's commitment to quality is based on years of experience working with healthcare professionals in an exacting and regulated environment, and is supported by an ISO 9001:2015 quality management system that is registered with a UKAS accredited certification body.

If you require further assistance, please do not hesitate to contact our Customer Service team who are here to help; or alternatively can arrange for your Regional Sales Representative to visit and help find a solution that best suits your requirements.



+44 (0)1258 484455



Monday to Friday - 8:30am - 5:00pm



Blandford Heights, Blandford Forum  
Dorset, DT11 7TG, UK



[www.bristolmaid.com](http://www.bristolmaid.com)



[sales@bristolmaid.com](mailto:sales@bristolmaid.com)

## Family Business

Hospital Metalcraft Ltd is a family company. We own our factory, production lines and delivery lorries. We continually invest into our staff and the development of new product ranges.

## Healthcare Focused

With an extensive portfolio that covers almost every discipline, we have solutions to cater for the demands of the healthcare environment.

## Manufactured In The UK

Hospital Metalcraft is proud to be a British manufacturing success story. Strict quality criteria are applied to both the Bristol Maid product range designed and produced within our own manufacturing facility, and complementary equipment from carefully selected partners.

## The Best Quality

With over 65 years' experience, we are focused on the design and manufacture of high-quality products which will create value for our customers. With a worldwide customer base, the Bristol Maid brand is recognised by many thousands of satisfied customers.

## Approved Supplier

We are an accredited NHS & public sector accredited supplier. This allows you to buy with confidence knowing your requirements for compliant and competitive tendering has already been met.

## Dedicated Support

Our external sales representatives, sales support engineers and our customer service team are here to help you at every stage, from advice with product selection, managing the delivery of your order through to full service and repair support.

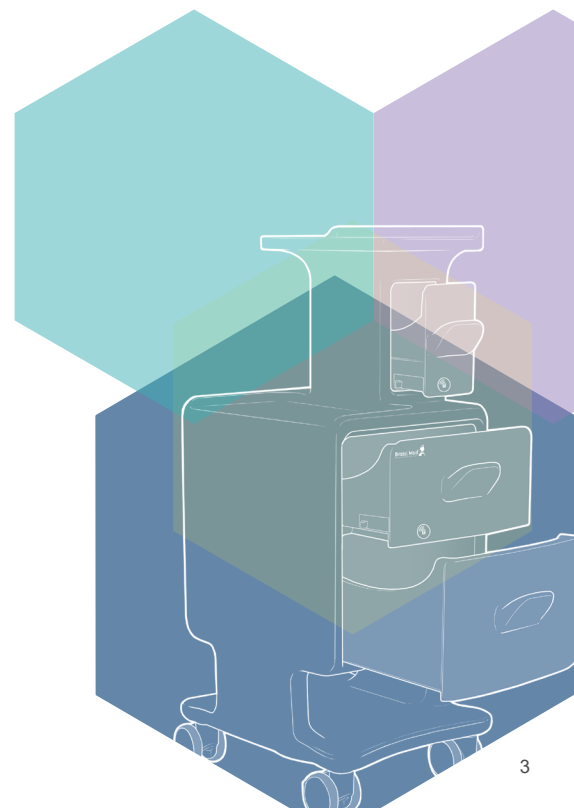
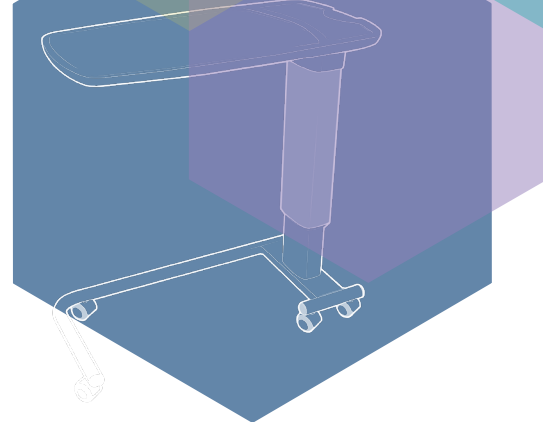

## The History of eClean

The Design Bugs Out challenge was launched with the aim to help reduce Healthcare Associated Infections (HCAI's) by designing hospital furniture & equipment which are quicker & easier to clean.

Working closely with nursing & infection control specialists, pharmacists & patients, we listened to their needs & concerns. After extensive trials, we developed our multiple award-winning Bedside Cabinet.

**Design  
Council**

We were tasked with designing a new bedside cabinet, focusing on enhancing effective cleaning as well as providing a better patient experience.

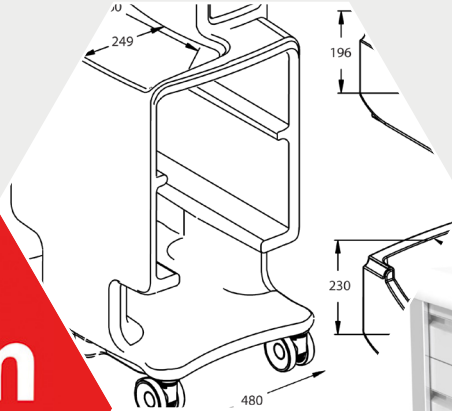



#### Multiple Award Winning...

- The Horners Award for Plastics Design & Innovation
- The Plastics Award 2010 (Industrial Product Design)
- The Building Better Healthcare Award for Best Product
- Design Guild Mark



**BBH**  
BUILDING BETTER HEALTHCARE



**Design  
Guild Mark**

The eClean Bedside Cabinet was launched & deployed in a number of hospitals around the UK.



Over 10 years later, the eClean range still features within our comprehensive product catalogue. Our focus & dedication has always been the needs of the Healthcare Environment.





EBC015



EBC030

# Bedside Cabinet - Polymer, Easy Clean

## Features

- BS 3962 Part 6:1980 - Assessment of resistance to mechanical damage
- BS EN 12720:2009 - Furniture assessment of surface resistance to cold liquids
- BS EN 12721:2009 - Furniture assessment of surface resistance to wet heat
- BS EN 12722:2009 - Furniture assessment of surface resistance to dry heat
- BS 5852:2006 - Methods of the test for assessment of the ignitability
- BS 4875-7:2006 - Domestic & contract storage furniture
- Manufactured from recyclable polyethylene
- Open backless design ensures that all areas are accessible, whilst surfaces allow for easy & effective cleaning
- Distinct upper, middle & lower zones
  - Upper - Nurse zone with integral rim to contain any spillages. Ideally positioned for staff to use while standing
  - Middle - Patient zone provides storage area for patient use
  - Lower - Patient zone provides shelf for washbowl, footwear etc.
- Drawers can be inserted from either side, allowing the cabinet to be positioned either side of the bed
- Upper & middle drawers can be fitted with an RFID lock, providing secure storage for patient medicines / property\*
- 100mm polymer twin-wheel braking castors

\*cabinets with locks are supplied with one patient card - a programming card will be required per ward / directorate as per hospital policy

## Dimensions (w x d x h)

- Overall Dimensions - 480 x 665 x 1237mm
- Drawers (internal)
  - Upper - 149 x 222 x 217mm
  - Middle - 338 x 491 x 197mm
  - Lower - 338 x 491 x 220mm

## Standard Colours

- Body - Grey White
- Drawers - Spearmint

## Options / Accessories

- RFID Cards

Item	Description	Weight
EBC015	No Locks	29.0kg
EBC020	Upper Drawer with Lock	29.1kg
EBC025	Middle Drawer with Lock	29.1kg
EBC030	Upper & Middle Drawers with Locks	29.2kg



# Overbed & Overchair Table - Height Adjustable, Polymer, Easy Clean

## Features

- BS 2483: 1977 Specification for overbed tables (selected tests)
- Finish Performance Tests (FIRA Standard 6250 2005)
  - BS 3962-6: 1980 Methods of test for finishes for wooden furniture
  - BS EN 12720: 2009 + A1: 2013 Assessment of surface resistance to cold liquids
  - BS EN 12721: 2009 + A1: 2013 Assessment of surface resistance to wet heat
  - BS EN 12722: 2009 + A1: 2013 Assessment of surface resistance to dry heat
- Height adjustable using a gas damper (760 - 1070mm)
- Safety feature prevents trapping of the patient between the bed / chair & table
- Extruded aluminium column provides a smooth linear height adjustment
- Cantilever tubular base available as...
  - C shaped suitable for use with beds & chairs
  - Straight leg suitable for use with bed
- Recyclable polypropylene one-piece top, smooth surfaces & radiused edges assists cleaning (compatible with steam cleaning)
- Raised edges reduces misplacement of objects & contains spillages
- 50mm polypropylene / thermoplastic rubber twin-wheel non-marking castors
- Maximum load 25kg

## Dimensions (w x d x h)

- Overbed Table - 895 x 440 x 760 - 1070mm
- Overchair Table - 918 x 440 x 760 - 1070mm
- Top - 880 x 440mm

## Standard Colours

- Top - Grey White
- Upper Extrusion - Spearmint
- Lower Extrusion / Base - Grey White

## Options / Accessories

- B - Braking Castors (x 2)



Item	Description	Weight
OBP/SP/S	Overbed Table - Height Adjustable, Polymer, Easy Clean	14.0kg
OCP/SP/S	Overchair Table - Height Adjustable, Polymer, Easy Clean	13.5kg





Alternative Upper Extrusion Colours Available



# Mobile Pump Stands - Polyurethane, Easy Clean

## Features

- Range of stands designed specifically to hold blood warmers, pumps & syringe drivers
- Five leg base with low centre of gravity to assist stability
- 32mm diameter 304 grade stainless steel upright & 25mm diameter pump support bows
- Polyurethane overmoulded base with smooth edges & contours provides...
  - Water-resistant finish, allowing for easy & effective cleaning (including steam cleaning)
  - Shield for the castors
  - Impact protection to patients & staff, reducing the risk of skin abrasions & bruising
  - Protection to the fabric of the building
- Height adjustable upright using a handwheel (1,300 - 2,000mm)
- Four U shaped hooks
- Maximum recommended load...
  - Hooks - 12kg per stand plus
  - Fixed Upright/s - 22kg per stand
- 75mm polypropylene / thermoplastic rubber twin-wheel castors (1 x anti-static)

## Dimensions (w x d x h)

- Overall - 620 x 620 x 1,300 - 2,000mm
- Vertical Clamping Area
  - PS/P/SC/4H - 975mm
  - PS/P/HC/4H - 771mm (upright) 2 x 646mm (support bows)

## Standard Colours

- Base - Grey
- Upright & Support Bows - Stainless Steel

## Vertical Clamping Area

- PS/P/SC/4H - 975mm
- PS/P/HC/4H - 771mm (upright) 2 x 646mm (support bows)



Smooth edges & contours, allows easy & effective cleaning

Item	Description	Weight
PS/P/SC/4H	Mobile Pump Stand - Polyurethane, Easy Clean, Standard Capacity, Four Hook	11.0kg
PS/P/HC/4H	Mobile Pump Stand - Polyurethane, Easy Clean, High Capacity, Four Hook	13.0kg



# eClean™

CE



Four U shaped hooks



Height adjustable upright using a heavy duty handwheel



PS/P/HC/4H  
(pumps not included)

# Mobile Infusion Stands - Polyurethane, Easy Clean



## Features

- Meets appendix A (Stability Requirements) of BS 3619:1976 Mobile Infusion Stands
- Five leg base with low centre of gravity to assist stability
- 25mm diameter 304 grade stainless steel upright
- Polyurethane overmoulded base with smooth edges & contours provides...
  - Water-resistant finish, allowing for easy & effective cleaning (including steam cleaning)
  - Shield for the castors
  - Impact protection to patients & staff, reducing the risk of skin abrasions & bruising
  - Protection to the fabric of the building
- Coloured indicator caps provide department identification & segregation, reducing the risk of cross contamination
- Height adjustable upright using a handwheel (1,260 - 2,100mm)
- Available with two or four pigtail hooks
- Maximum recommended load...
  - Hooks - 4kg per stand plus
  - Fixed Upright - 4kg per stand
- Optional handle keeps feet clear of the base, assists manoeuvrability & improves patient safety
- 50mm polypropylene / thermoplastic rubber twin-wheel non-marking castors (1 x anti-static)

## Dimensions (w x d x h)

- Overall - 620 x 620 x 1,260 - 2,100mm
- Vertical Clamping Area
  - IS/P/2H & IS/P/4H - 970mm
  - IS/P/2H/H & IS/P/4H/H - 840mm

## Standard Colours

- Base - Grey
- Upright & Handle - Stainless Steel
- Coloured Indicator Cap - Spearmint

## Options

- Coloured Indicator Cap - Blue / Green / Red / Yellow



BL  
Blue



GR  
Green



RD  
Red



YE  
Yellow



4 hook pole supplied with models with '4H' product code suffix



Spearmint	Blue	Green	Red	Yellow	Description	Weight
IS/P/2H/SP	IS/P/2H/BL	IS/P/2H/GR	IS/P/2H/RD	IS/P/2H/YE	Two Hook	7.8kg
IS/P/4H/SP	IS/P/4H/BL	IS/P/4H/GR	IS/P/4H/RD	IS/P/4H/YE	Four Hook	7.9kg
IS/P/2H/H/SP	IS/P/2H/H/BL	IS/P/2H/H/GR	IS/P/2H/H/RD	IS/P/2H/H/YE	Two Hook, Handle	8.2kg
IS/P/4H/H/SP	IS/P/4H/H/BL	IS/P/4H/H/GR	IS/P/4H/H/RD	IS/P/4H/H/YE	Four Hook, Handle	8.3kg



IS/P/2H/GR



IS/P/2H/BL

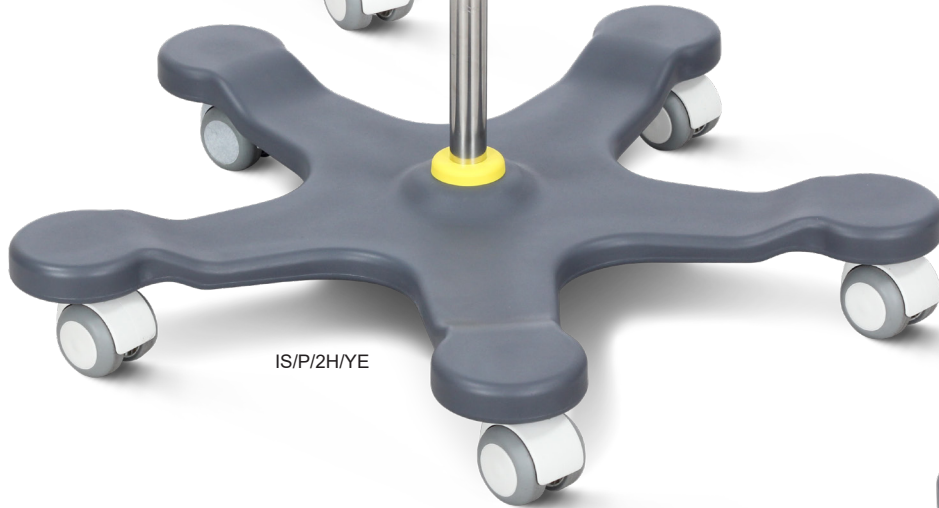

IS/P/2H/YE



IS/P/2H/RD

eClean™

## Manufacturing Medical Furniture & Equipment Since 1953

With over 65 years of experience, Bristol Maid is a leading manufacturer and supplier of medical furniture & equipment.

From design and manufacture to supply and installation, Bristol Maid has a reputation for providing high product quality, excellent customer service and value for money.

We take pride in working in close partnership with our customers applying innovative design and technology to deliver effective solutions for today while anticipating the needs of tomorrow.



Hospital Metalcraft Limited  
Blandford Heights, Blandford Forum,  
Dorset. DT11 7TG, UK

Tel: +44 (0) 1258 451338  
Fax: +44 (0) 1258 455056  
[sales@bristolmaid.com](mailto:sales@bristolmaid.com)

[www.bristolmaid.com](http://www.bristolmaid.com)

MKT-090623-262-1

